





DIAL 1100  
BEFORE YOU DIG

NOTE  
OBTAIN ROAD OPENING PERMIT  
FROM COUNCIL PRIOR TO THE  
COMMENCEMENT OF ANY  
WORKS IN ROAD RESERVE

NOTE

LOCATION OF SURFACE STORMWATER  
GRADED INLET PITS AND ROOF DOWNPipes  
SUBJECT TO VERIFICATION AND LOCATION  
BY BUILDER DURING CONSTRUCTION

TREE PRESERVATION NOTE

IT IS THE RESPONSIBILITY OF THE CONTRACTOR  
TO OBTAIN ANY PRIOR APPROVAL REQUIRED FROM  
COUNCIL WITH RESPECT TO POTENTIAL IMPACT ON  
TREES FOR ANY WORKS SHOWN ON THIS DRAWING  
PRIOR TO THE COMMENCEMENT OF THOSE WORKS.

PIT P1 : 600 x 600  
SOLID BOLT-DOWN LID : RL 20.60  
INVERT : RL 19.80

COREDRIIL CONNECT TO KERB INLET PIT  
TO COUNCIL SPECIFICATION.  
CONNECTION INVERT RL 19.70  
TO BE CONFIRMED PRIOR TO  
COMMENCEMENT OF WORKS.  
NOTE : COUNCIL INSPECTION  
REQUIRED PRIOR TO BACKFILL.

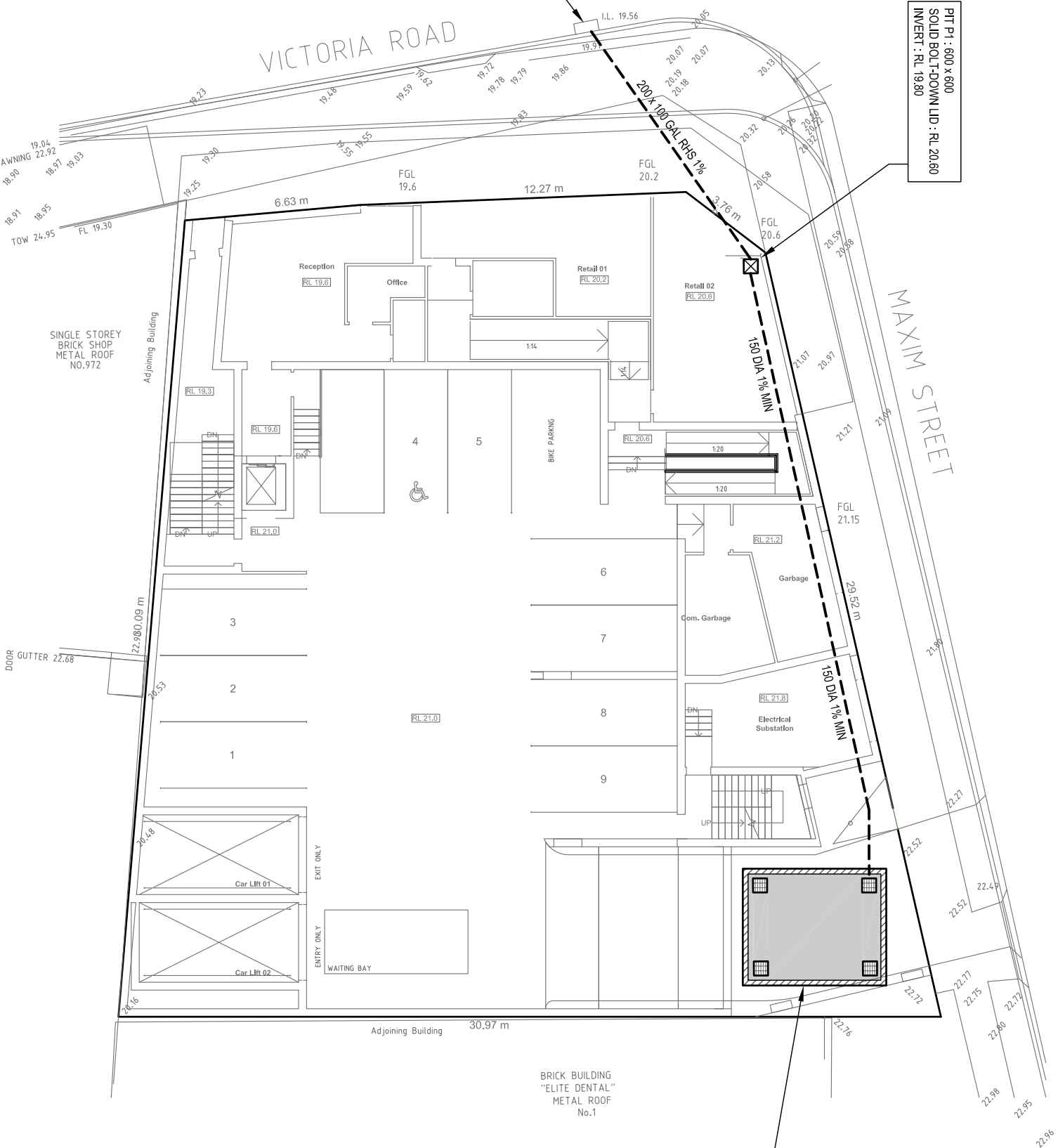

BELOW DRIVEWAY STORMWATER DETENTION TANK  
TANK GRATES = RL 22.50 - 22.30  
TANK 150 DIA OUTLET INVERT = RL 20.50  
TANK 150 DIA OVERFLOW PIPE INVERT : RL 21.70  
DESIGN TOP WATER LEVEL = RL 21.70  
TANK FLOOR INVERT = RL 20.70 - 20.60  
INTERNAL DIMENSIONS : 4.0 x 5.0 = 20.0 m2  
DESIGN WATER STORAGE DEPTH = 1.0m  
DESIGN STORAGE VOLUME = 20 x 1.0 = 20.0 m3  
REFER DETAIL DRAWING D1.  
NOTE : ALL ROOF WATER DOWNPIPES TO BE  
DIRECTED TO DETENTION TANK

CONCEPT STORMWATER MANAGEMENT PLAN

SCALE 1:200 A3

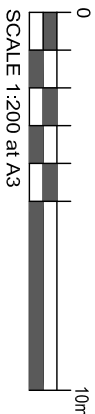
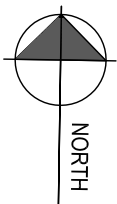

NOTE  
THIS DRAWING IS NOT TO BE USED  
FOR SETOUT PURPOSES - REFER  
TO ARCHITECTURAL DRAWINGS

NOTE  
THIS DRAWING IS TO BE READ  
IN CONJUNCTION WITH  
ARCHITECTURAL DRAWINGS

NOTE

THIS DRAWING IS FOR  
DEVELOPMENT APPLICATION ONLY  
AND IS NOT FOR CONSTRUCTION

STRUCTURAL FOOTING NOTE

ALL STRUCTURES IN VICINITY OF  
UNDERGROUND STORMWATER  
FACILITIES PROPOSED IN THIS  
DRAWING ARE TO BE FOUNDED TO  
BELOW THE ZONE OF INFLUENCE  
OF THE DRAINAGE STRUCTURES.

NOTE

ALL ROOF GUTTERS TO HAVE OVERFLOW  
PROVISION IN ACCORDANCE WITH  
AS 3500.3:2003 AND SECTIONS 3.5.3,  
3.7.5 AND APPENDIX G OF AS 3500.3:2003.

B	03.05.2021	ARCH AMENDS
A	07.12.2018	DA ISSUE
ISS	DATE	AMENDMENT

ARCHITECT	ARCH. REF : 4281
PETER HALL ARCHITECTS	
CLIENT	
LGA	RYDE COUNCIL

Consulting Engineers  
Civil & Environmental  
Stormwater Management.  
3 Gresham Street  
Cowan 2081  
ph/fax (02) 9456 7233  
mobile : 0424023047  
mark@stormcivil.com.au

StormCivil

Pty Ltd. ABN 71 612 151 461

DWG TITLE
CONCEPT STORMWATER MANAGEMENT PLAN
PROJECT TITLE
PROPOSED AFFORDABLE RENTAL HOUSING DEVELOPMENT Lot 2, No 964-970 VICTORIA ROAD, WEST RYDE

StormCivil		APPROVED ON BEHALF OF STORMCIVIL PT LTD	
JOB No	DWG No	No IN SET	ISSUE
301331	S2	2	B