

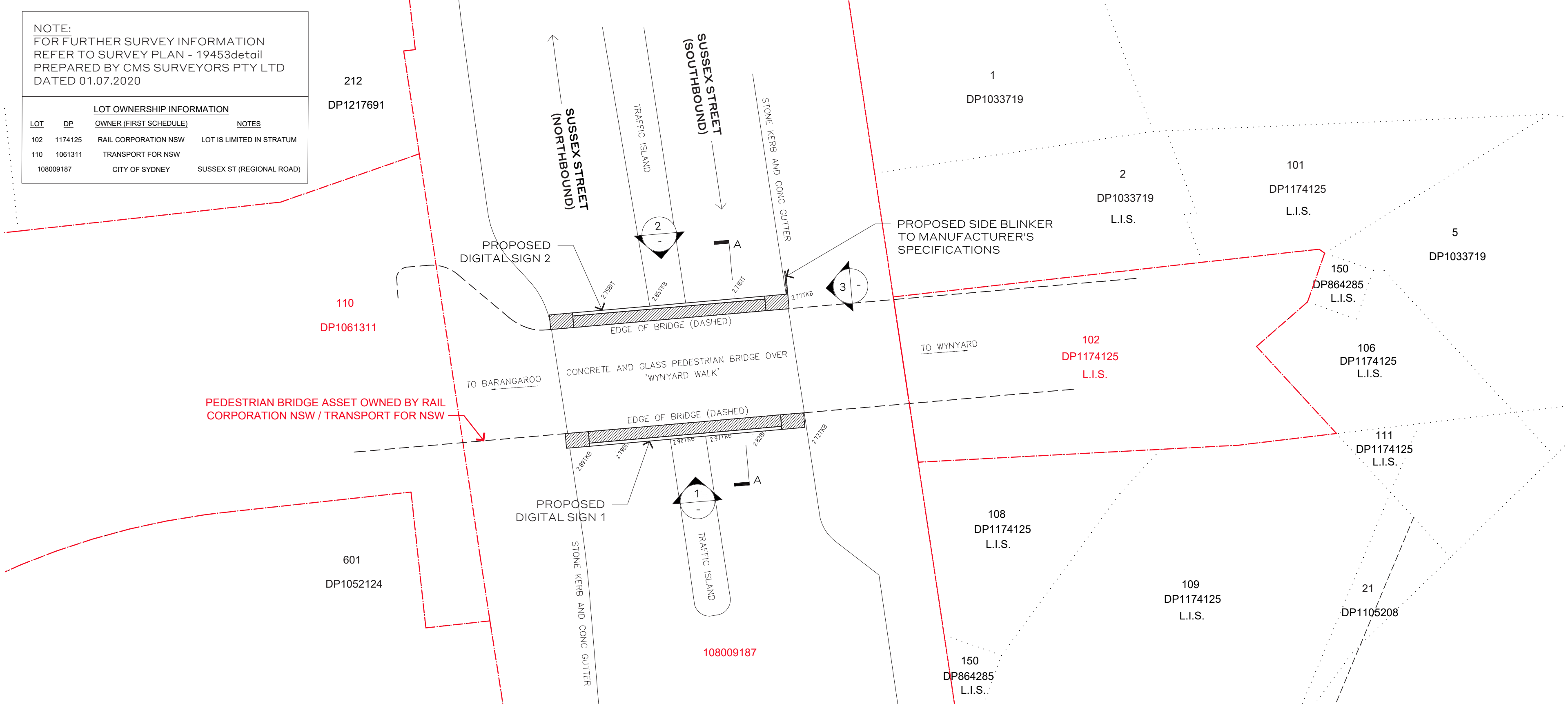

LOCATION PLAN -
AERIAL PHOTO

NTS



SITE PLAN

SCALE 1:200 @ A1

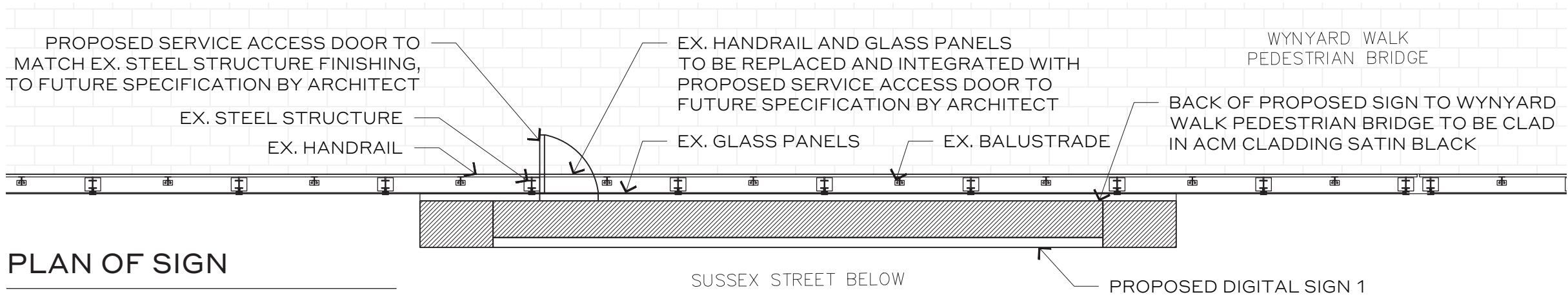

PLAN OF SIGN

SCALE 1:100 @ A1

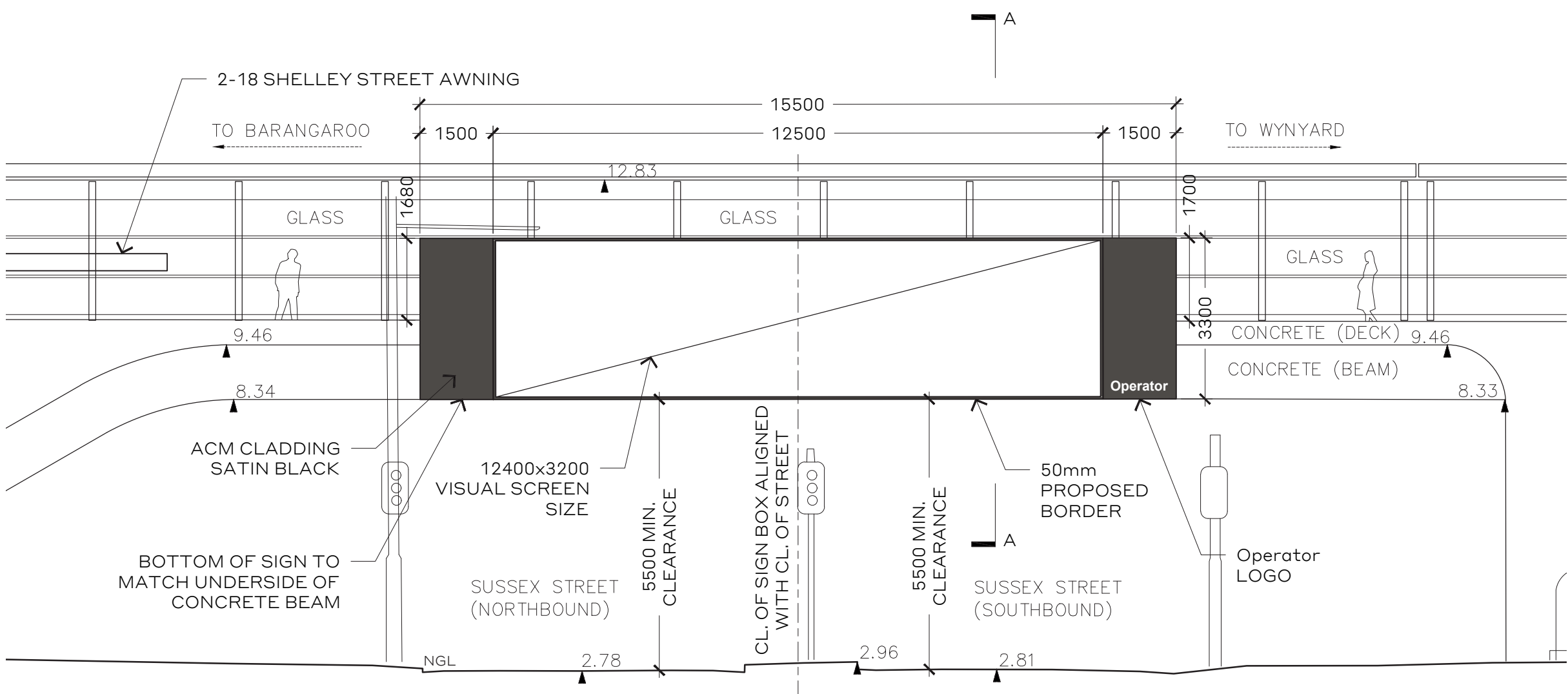

SOUTH ELEVATION

SCALE 1:100 @ A1

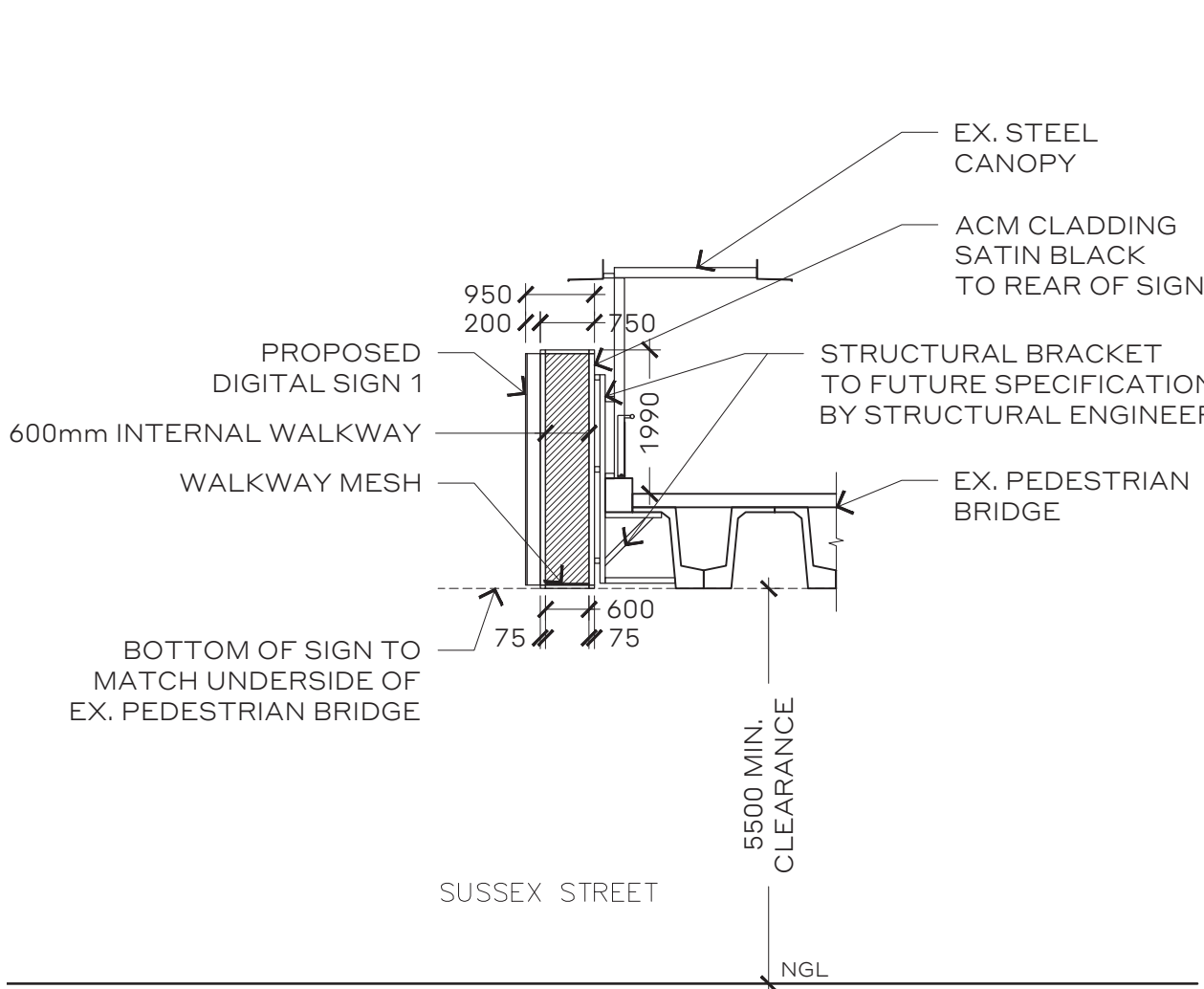

SECTION A-A

SCALE 1:100 @ A1



PHOTOMONTAGE - VIEW 1

View from Sussex Street looking north

NOT FOR CONSTRUCTION

ETHOS
URBAN

Ethos Urban Pty. Ltd.
ABN 13 615 087 931 ACN 615 087 931
www.ethosurban.com
173-185 Sussex Street Sydney NSW 2000
t +61 2 9956 6962

DISCLAIMER

This drawing shall only be used for the purpose for which it was commissioned. Unauthorised use of the drawings is prohibited. Do not scale this drawing. Use only figured dimensions. Report any discrepancy to the Architect or Urban Designer for clarification prior to the commencement of any work.

LEGEND / NOTES

- Site boundary
- Photomontage location
- Proposed sign (NTS)

- ACM Aluminium composite material
- CL Centre line
- EX Existing
- LIS Limited in stratum

ISSUE	DATE	REVISION	REVISION BY	APPROVED BY
A	09.11.20	DA Issue to DPIE	PN	SM
B	18.02.21	Response to Submissions	PN	SM

RESPONSE TO SUBMISSIONS - DA 10646

PROJECT

DOOH Development Applications
Prepared for Sydney Trains

DRAWING

Site Plan & General Arrangement 1
Site 3 - Sydney CBD (Sussex Street - Southern Side)

A-3.1
/B

JOB NO.	DWG NO.	ISSUE	DATE	DRAWN BY
2200249	A-3.1	B	18.02.21	PN



LOCATION PLAN -
AERIAL PHOTO

NTS

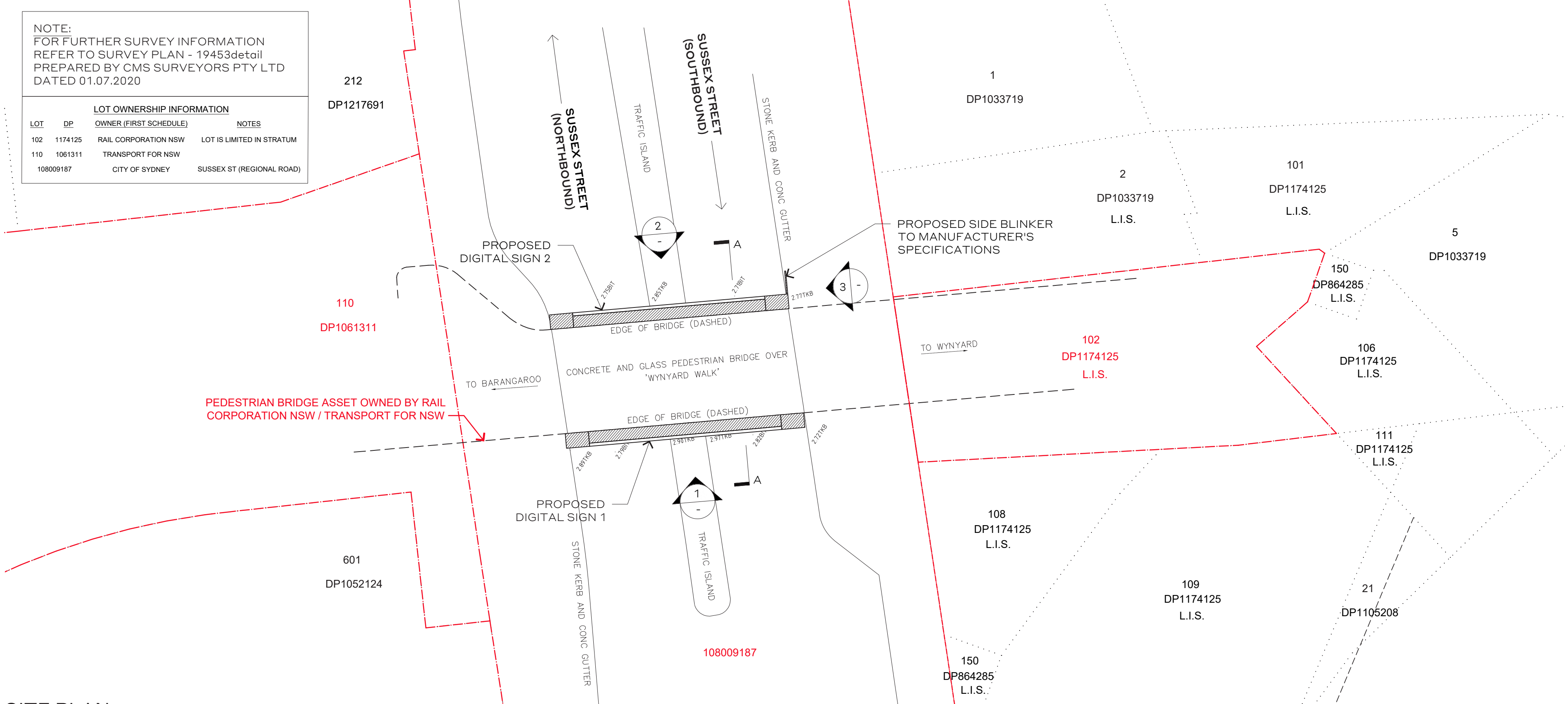

SITE PLAN

SCALE 1:200 @ A1

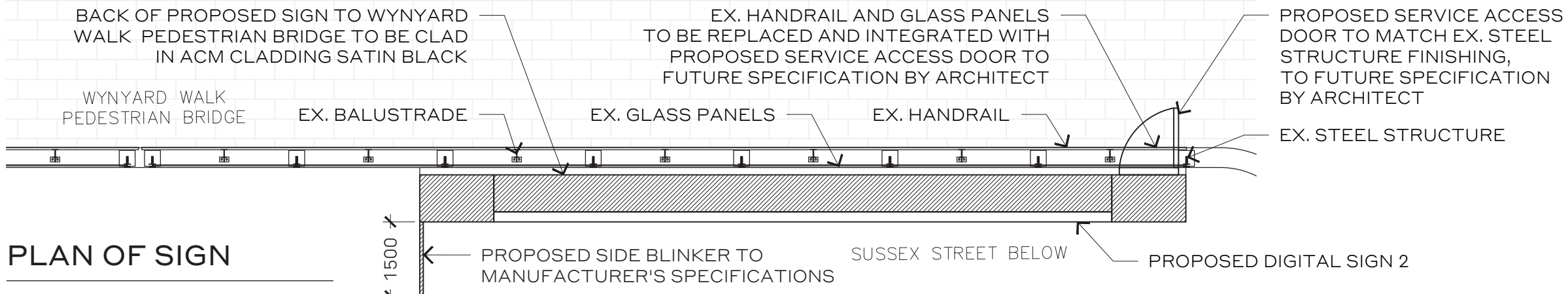

PLAN OF SIGN

SCALE 1:100 @ A1

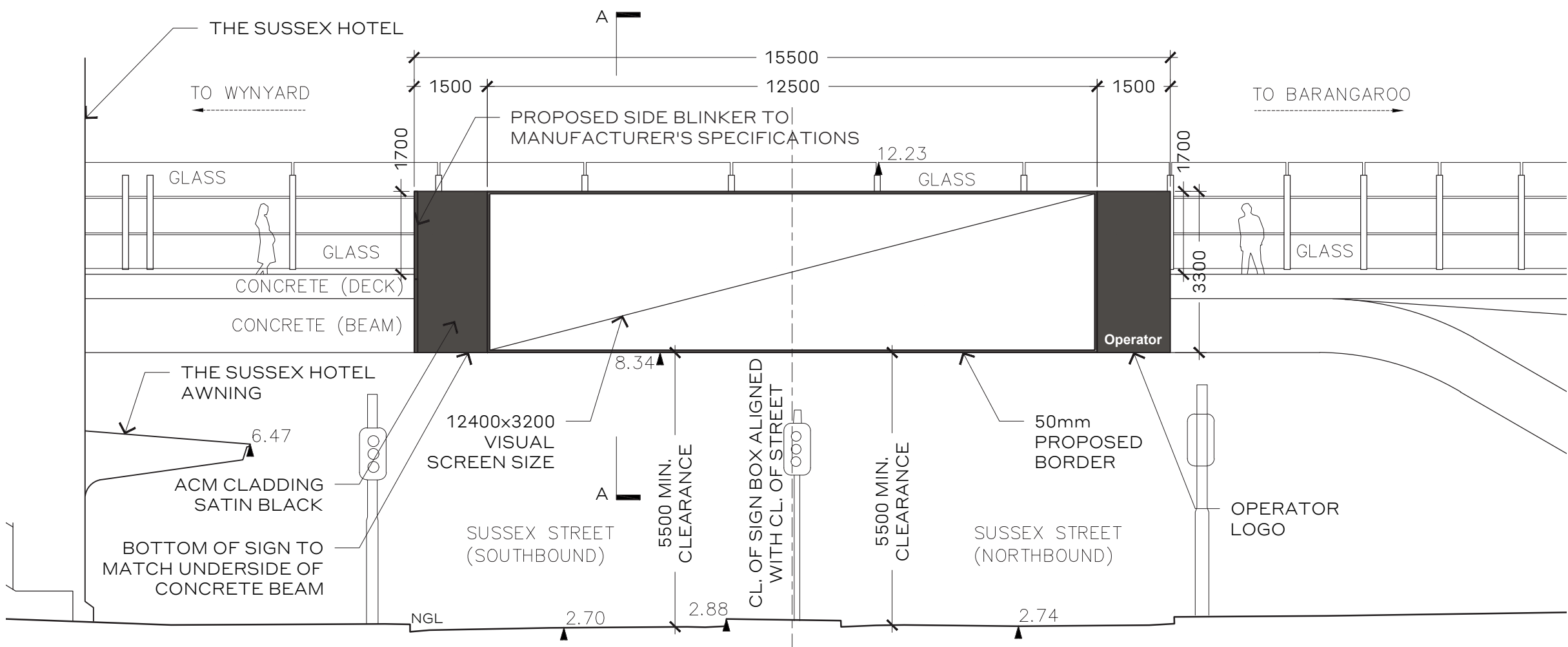

NORTH ELEVATION

SCALE 1:100 @ A1

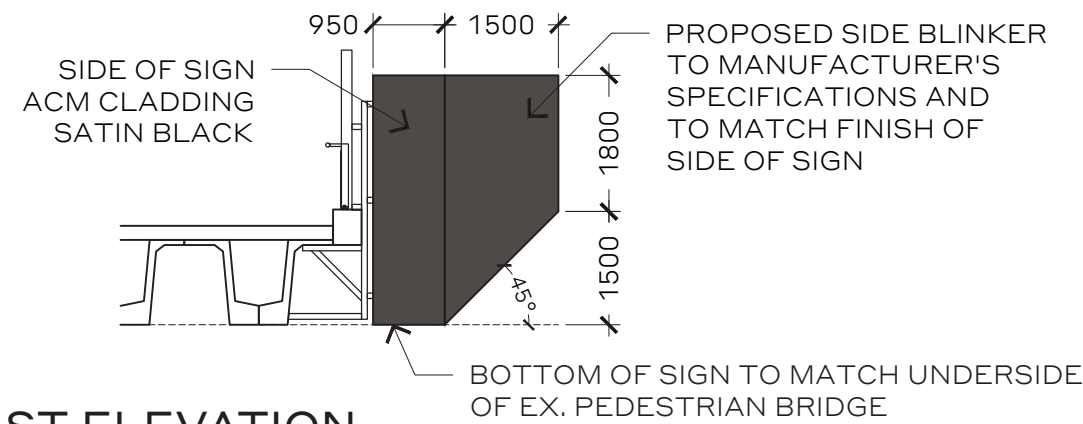

EAST ELEVATION

SCALE 1:100 @ A1

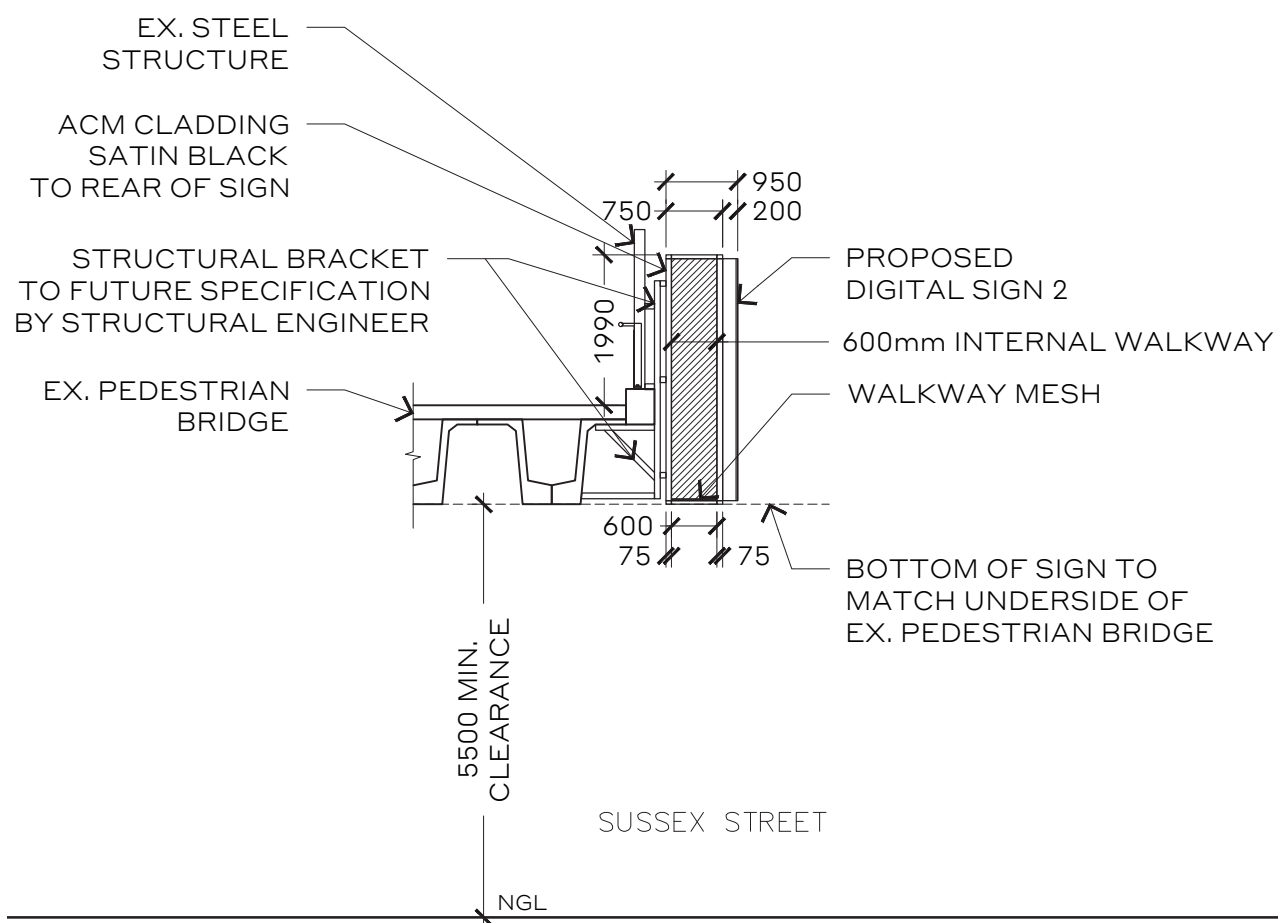

SECTION A-A

SCALE 1:100 @ A1



PHOTOMONTAGE - VIEW 2

View from Sussex Street looking south

NOT FOR CONSTRUCTION

ETHOS
URBAN

Ethos Urban Pty. Ltd.
ABN 13 615 087 931 ACN 615 087 931
www.ethosurban.com
173-185 Sussex Street Sydney NSW 2000
t +61 2 9956 6962

DISCLAIMER

This drawing shall only be used for the purpose for which it was commissioned. Unauthorised use of the drawings is prohibited. Do not scale this drawing. Use only figured dimensions. Report any discrepancy to the Architect or Urban Designer for clarification prior to the commencement of any work.

LEGEND / NOTES

- Site boundary
- Photomontage location
- Proposed sign (NTS)

- ACM Aluminium composite material
- CL Centre line
- EX Existing
- LIS Limited in stratum

ISSUE	DATE	REVISION	REVISION BY	APPROVED BY
A	09.11.20	DA Issue to DPIE	PN	SM
B	18.02.21	Response to Submissions	PN	SM

RESPONSE TO SUBMISSIONS - DA 10646

PROJECT

DOOH Development Applications
Prepared for Sydney Trains

DRAWING

Site Plan & General Arrangement 2
Site 3 - Sydney CBD (Sussex Street - Northern Side)

A-3.2
/B

JOB NO.	DWG NO.	ISSUE	DATE	DRAWN BY
2200249	A-3.2	B	18.02.21	PN